



# Excellent Distribution Space

## 3230 Reed Avenue, West Sacramento



### ±32,000 Square Feet Available



#### Contact Exclusive Agent

**Kevin Jasper**  
kjasper@ccarey.com  
916.569.2325

[www.ccarey.com](http://www.ccarey.com)

CORNISH & CAREY COMMERCIAL  
ONCOR INTERNATIONAL  
1601 RESPONSE ROAD, SUITE 160  
SACRAMENTO, CA 95815  
TEL: 916.920.4400  
FAX: 916.920.0854

The information contained herein has been given to us by the owner of the property or other sources we deem reliable. We have no reason to doubt its accuracy, but we do not guarantee it. All information should be verified prior to purchase or lease.

#### Project Highlights

- For Lease
- ±3,000 Square Feet of Office Space
- Seven (7) Dock-High Doors
- Two (2) Grade Level Doors
- 24' Clear Height
- Excellent Freeway Access
- Interstate 80 Signage Available
- Additional On-Site Truck Parking Potentially Available
- Site Plan on Reverse

# 3230 Reed Avenue, West Sacramento

## Floorplan

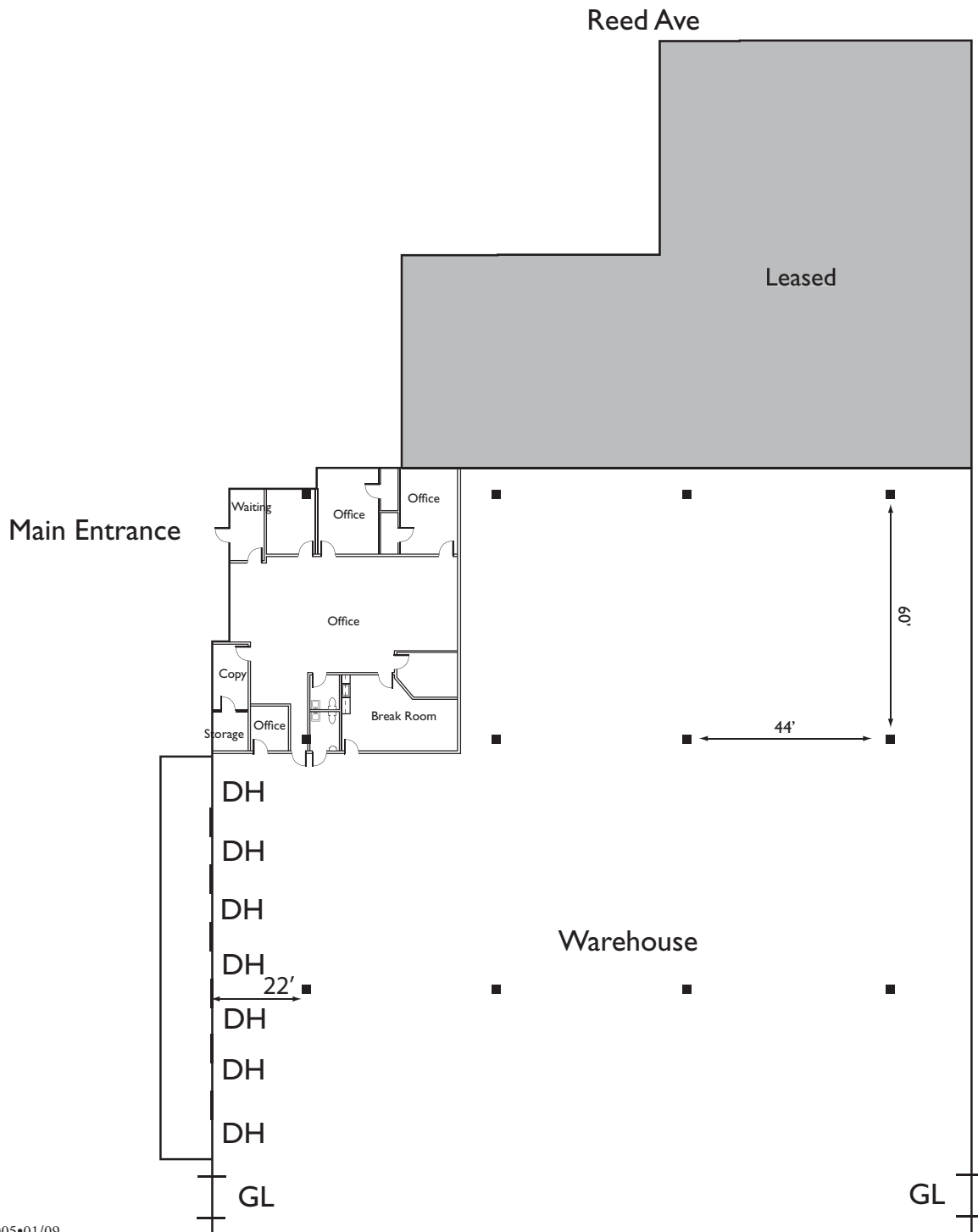

09-0005•01/09

### Contact Exclusive Agent

**Kevin Jasper**  
kjasper@ccarey.com  
916.569.2325

[www.ccarey.com](http://www.ccarey.com)

CORNISH & CAREY COMMERCIAL  
ONCOR INTERNATIONAL  
1601 RESPONSE ROAD, SUITE 160  
SACRAMENTO, CA 95815  
TEL: 916.920.4400  
FAX: 916.920.0854

# 3230 Reed Avenue, West Sacramento

## Site Plan

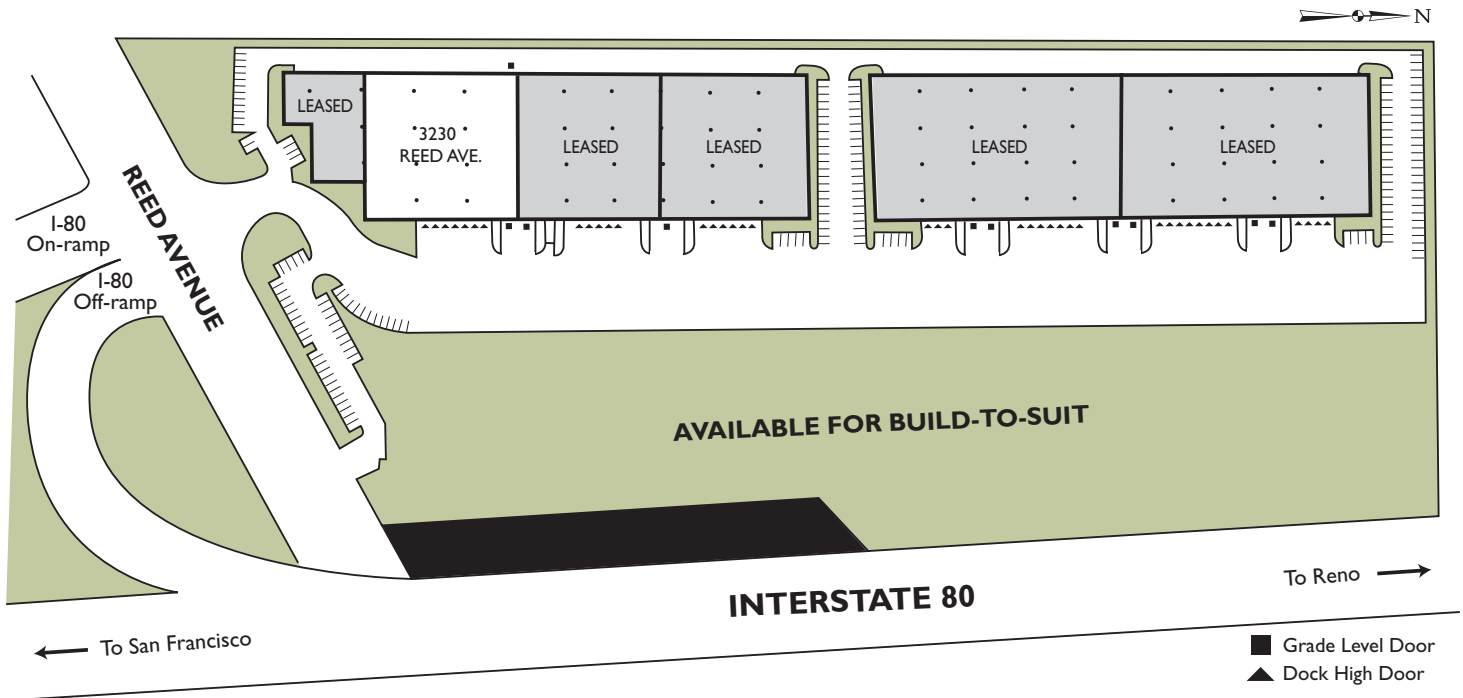

09-0005-01/09

## Location Map



### Contact Exclusive Agent

**Kevin Jasper**

kjasper@ccarey.com

916.569.2325

[www.ccarey.com](http://www.ccarey.com)

CORNISH & CAREY COMMERCIAL  
ONCOR INTERNATIONAL  
1601 RESPONSE ROAD, SUITE 160  
SACRAMENTO, CA 95815  
TEL: 916.920.4400  
FAX: 916.920.0854